



**Casey &
Company
Forestry,
PLLC**

PO Box 955
Wilkesboro, NC 28697
Phone: (336) 838-5766
Fax: (336) 838-4465
www.caseyandcompany.com

Invitation to Bid On Timber Owned By Scott Clark

**27 +/- Acres
Sale Date – 11:00 AM – October 21st, 2010**

SAWTIMBER	
Beech	4,400
Black Birch	8,600
Black Cherry	1,000
Black Oak	3,600
Chestnut Oak	18,200
Cucumber	3,000
Sugar Maple	400
Hemlock	12,100
Hickory	5,800
Fraser Magnolia	2,100
Northern Red Oak	46,400
Red Maple	6,700
Scarlet Oak	2,700
Southern Red Oak	900
White Oak	2,800
White Pine	4,800
Yellow Poplar	68,900
Sawtimber Totals (bf) 192,400	

PULPWOOD	
Pine Pulpwood	30
Hard Hardwood Pulp	107
Soft Hardwood Pulp	195
Pulpwood Totals (Tons) 332	

LOCATION and ACCESS: The tract is located in Watauga County, North Carolina. From the intersection of Highway 221 and 421 in Deep Gap head north on Highway 221. Proceed 1.9 miles and turn left onto Cranberry Springs Road. Proceed 2.9 miles and turn right at Brownwood Road. Proceed .6 miles and turn left onto Todd Railroad Grade Road. Proceed 3.4 miles and turn left onto Riverbend Lane where there is a locked iron gate. On the right side of the gate is a lockbox with a key inside. The combination for the lockbox is 2048. Once you are through the gate cross the bridge and follow the blue and red flagging to the timber sale area.

TIMBER SHOWING: You are invited to look at the timber in the sale area at your convenience. Please call if you would like a personal showing or more information concerning the sale.

TIMBER INVENTORY: The volumes for the Mixed Hardwood stand are based on a systematic, variable point sample. Acreage estimates are based on data taken with a resource grade GPS unit. The volumes for the Marked Sale are based on a 100 percent tree count. Hardwood sawtimber was tallied to a 10 inch or merchantable top. Pine sawtimber was tallied to an 8 inch or merchantable top. Pulpwood was tallied to a 4 inch or merchantable top. No topwood pulpwood is included in this volume estimate. Deductions for visible defects were made in the field. All sawtimber volumes are expressed in International ¼ inch Log Rule, form class 78. Pulpwood volumes are expressed in tons. These volumes are an estimate and cannot be guaranteed.

SALE INFORMATION: Bids for the timber will be received as a lump sum cash offer. No other terms will be accepted. The timber and pulpwood in the Mixed Hardwood are being sold on a clearcut basis. Only orange painted trees will be sold in the marked sale areas. Bids will be accepted by phone at 336-838-5766; by fax at 336-838-4465; by email at cneggers@caseyandcompany.com, or by personal delivery to the office of Casey & Company Forestry, PLLC until 11:00 AM on Thursday, October 21st 2010. All faxes and emails will be confirmed by telephone prior to the bid opening. The owner reserves the right to reject any and all bids. The successful bidder will be notified within 24 hours of the bid opening. The successful bidder may be required to make a 10 percent deposit within 24 hours of notification. The balance will be paid in full within 30 days from the date of acceptance. The sellers will be responsible for timber deed preparation. The buyer will be responsible for all other closing costs. A \$2,000 performance deposit will be payable at closing and held in a non-interest bearing trust account until satisfactory completion of logging. The performance deposit does not limit the buyer's liability.

CONDITIONS OF THE SALE:

1. The Buyer will have 24 months, from the time of timber deed, to complete all timber-harvesting activities.
2. Casey & Company Forestry, PLLC will be notified at least 48 hours in advance of the initiation of logging activities, and 48 hours in advance of completion.
3. No trees, limbs, or other logging debris will be left in or across the sale boundaries. Debris will be removed immediately.
4. All requirements concerning stream obstructions as found in the NC General Statutes must be honored. The Buyer is also required to comply with the Best Management Practices as established by The State of North Carolina.
5. No boundary line trees or other trees not included in the sale will be cut. If any are cut, they will be paid for at the rate of \$400/MBF International ¼ log rule. The sale boundaries are marked with red paint and flagging, the boundaries of the marked sale area are marked with blue paint and flagging.
6. The Buyer agrees to indemnify and save harmless the Seller and his agents against all claims which may arise in connection with the Buyer's operations on the described tract, including fines resulting from poor logging practices or Workers Compensation Claims. Buyer guarantees their loggers will be covered by Workers Compensation and General Liability Insurance in the amount of 1 million dollars and will provide satisfactory evidence of coverage at closing and maintain same throughout all logging operations.
7. Trash will be kept picked up at all times. All trash will be removed from the property, not buried.
8. This contract may not be sold or assigned without written permission of the Seller.
9. Casey & Company Forestry retains the right to suspend the logging operation in the event of excessive wet weather or due to poor performance from the logger. Extensions may be granted for weather related suspensions.
10. The logger must complete a pre-harvest inspection with Casey & Company Forestry, PLLC.
11. The logging contractor must be pre-approved by Casey & Company Forestry, PLLC

Scott Clark Tract Watauga County, N.C. Volume Summary¹

Stand Type	Mixed Hardwood	Marked Sale	Totals	Percent of Board Feet by Grade		
Stand Acres	13.2	14.1	27.3			
Avg. Volume per Acre (Mbf)	12.6	1.9	7.0			
Species	Sawtimber ² (Mbf)			Grade 1	Grades 2 & 3	Grade 4
Beech	4.4		4.4			
Black Birch	8.6		8.6			
Black Cherry	0.7	0.3	1.0	20%	80%	0%
Black Oak	3.6		3.6	47%	53%	0%
Chestnut Oak	17.0	1.2	18.2	26%	74%	0%
Cucumber	3.0		3.0			
Sugar Maple	0.4		0.4	0%	100%	0%
Hemlock	12.1		12.1			
Hickory	5.0	0.8	5.8			
Fraser Magnolia	2.1		2.1			
Northern Red Oak	33.4	13.0	46.4	77%	23%	0%
Red Maple	6.7		6.7	15%	85%	0%
Scarlet Oak	1.7	1.0	2.7	11%	89%	0%
Southern Red Oak	0.9		0.9	100%	0%	0%
White Oak	2.8		2.8	18%	82%	0%
White Pine	3.0	1.8	4.8			
Yellow Poplar	60.6	8.3	68.9	61%	38%	1%

Sawtimber Totals (Mbf)	166.0	26.4	192.4
-------------------------------	-------	------	-------

Product	Pulpwood ³ (Tons)	
Pine Pulpwood	30	30
Hard Hardwood Pulp	107	107
Soft Hardwood Pulp	195	195

Pulpwood Totals (Tons)	332	0	332
-------------------------------	-----	---	-----

1 The volumes are an estimate and cannot be guaranteed.

2 The sawtimber volumes are reported in units of thousand board feet and were calculated using International 1/4 inch Log Rule, Form Class 78. 45 plots were taken as part of this inventory.

3 The pulpwood volumes are reported in tons and were calculated with tables developed by Dr. Richard Oderwald.



**Casey &
Company
Forestry,
PLLC**

PO Box 955
Wilkesboro, NC 28697
Phone: (336) 838-5766
Fax: (336) 838-4465
www.caseyandcompany.com

**Scott Clark
Watauga County, NC
Scale 1 Inch = 400 Feet
Contour Interval: 20 Feet**



Red and Blue Flagging Along Road

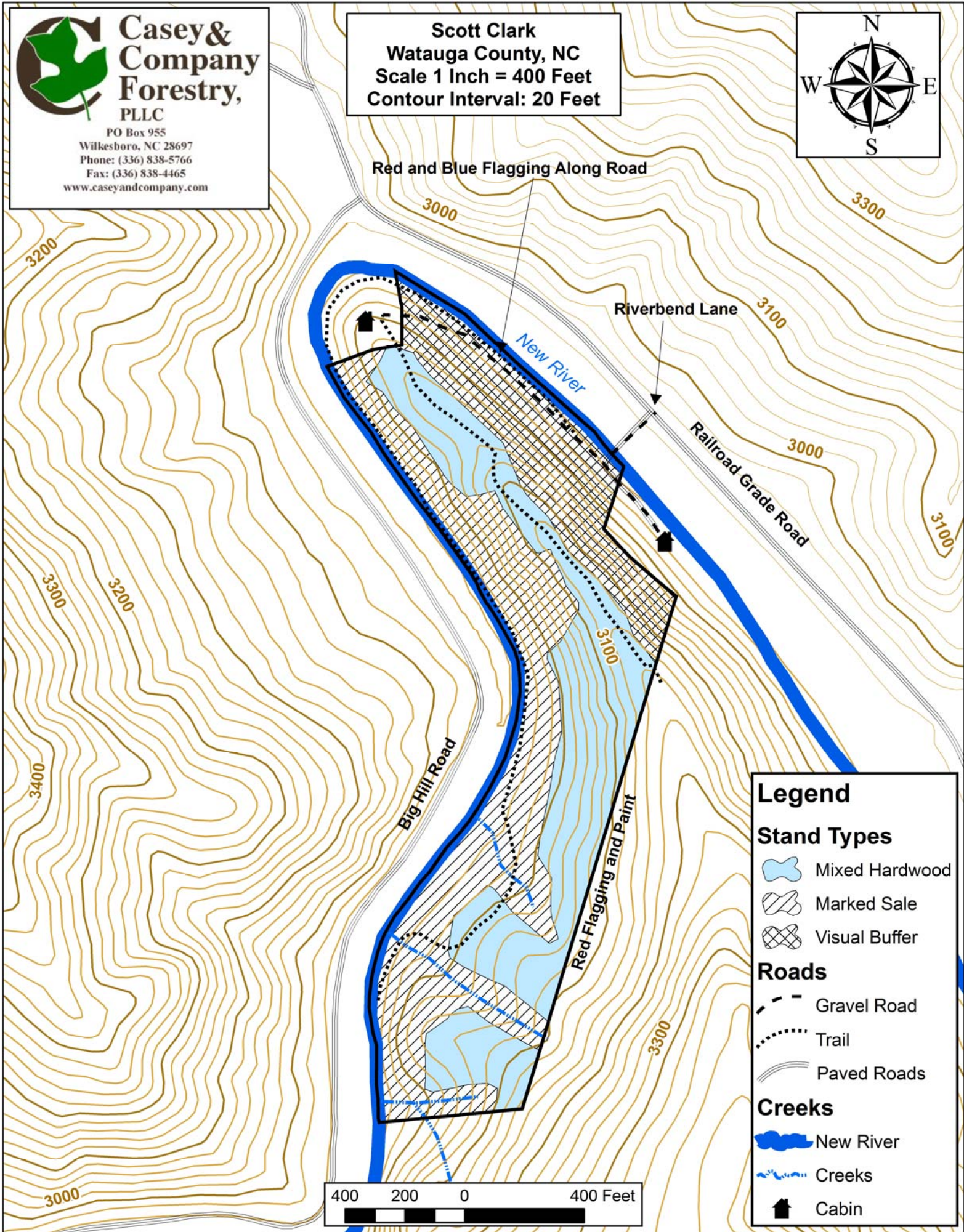

Legend

Stand Types

- Mixed Hardwood
- Marked Sale
- Visual Buffer

Roads

- Gravel Road
- Trail
- Paved Roads

Creeks

- New River
- Creeks
- Cabin

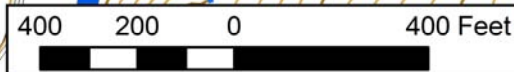



**Casey &
Company
Forestry,
PLLC**

PO Box 955
Wilkesboro, NC 28697
Phone: (336) 838-5766
Fax: (336) 838-4465
www.caseyandcompany.com

**Scott Clark
Watauga County, NC
Scale 1 Inch = 400 Feet**



Red and Blue Flagging Along Road

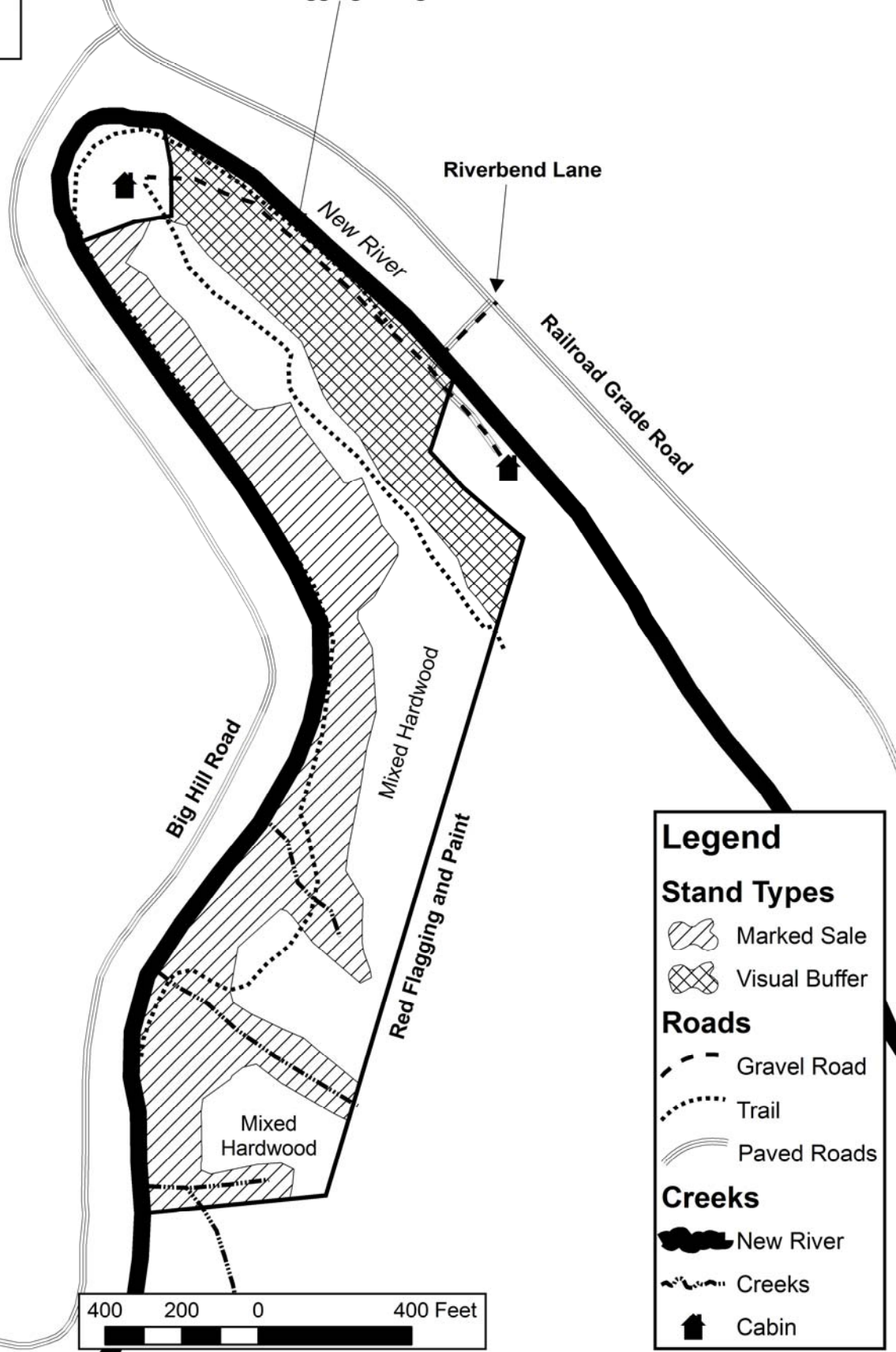

Legend

Stand Types

- Marked Sale
- Visual Buffer

Roads

- Gravel Road
- Trail
- Paved Roads

Creeks

- New River
- Creeks
- Cabin

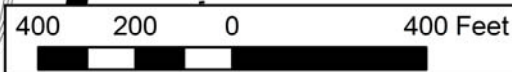

**Scott Clark
Watauga County, NC**

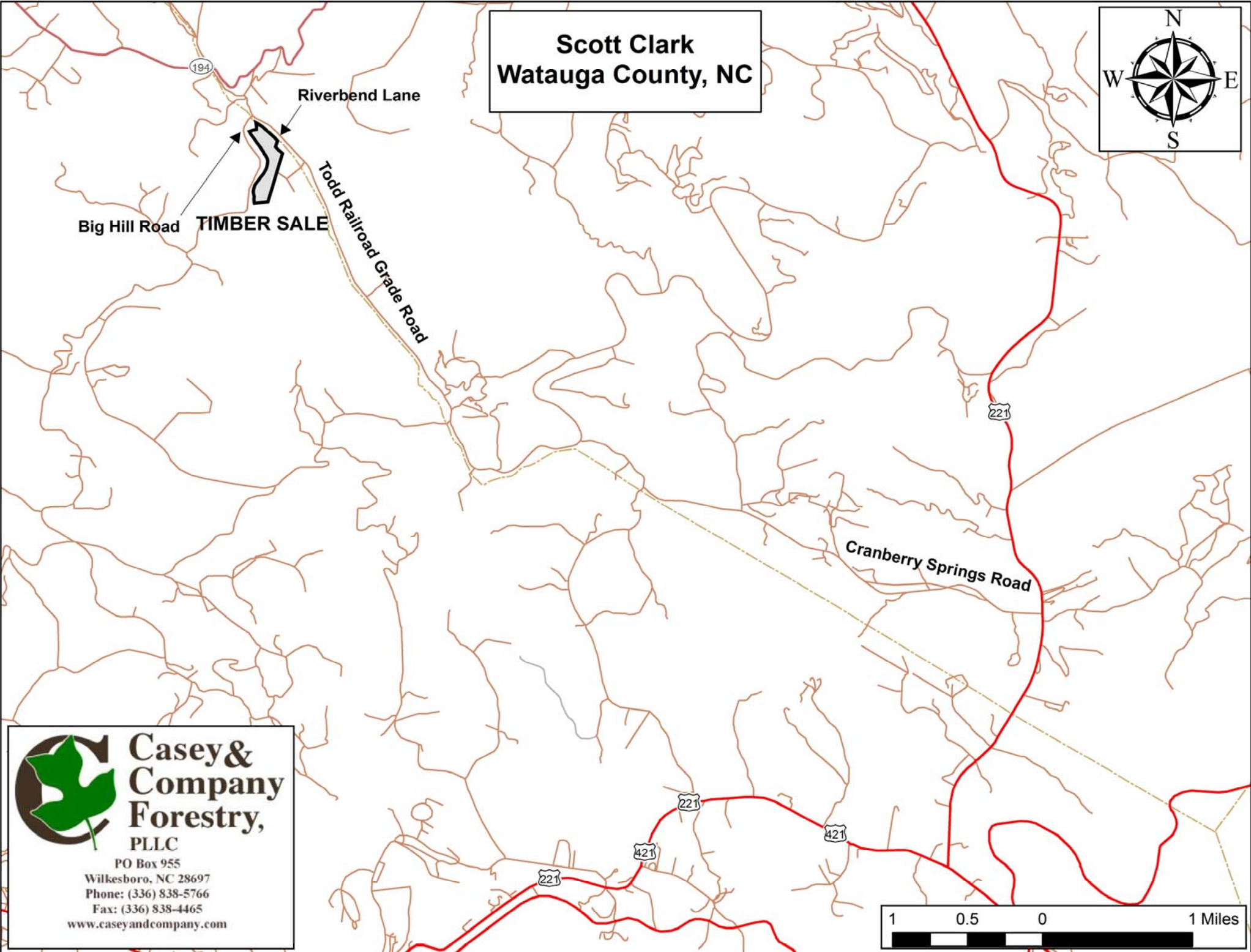

Riverbend Lane

Big Hill Road **TIMBER SALE**

Todd Railroad Grade Road

Cranberry Springs Road



**Casey &
Company
Forestry,
PLLC**

PO Box 955
Wilkesboro, NC 28697
Phone: (336) 838-5766
Fax: (336) 838-4465
www.caseyandcompany.com

