



**Casey &
Company
Forestry,
PLLC**

PO Box 955
Wilkesboro, NC 28697
Phone: (336) 838-5766
Fax: (336) 838-4465
www.caseyandcompany.com

**Invitation to Bid
On Timber Owned By
Fern Absher**

**9 +/- Acres
Sale Date – 11:00 AM –February 25th, 2010**

Sawtimber	
Beech	2,200
Black Birch	600
Black Cherry	100
Black Locust	300
Chestnut Oak	22,200
Cucumber	600
Hickory	8,700
Fraser Magnolia	600
Northern Red Oak	3,200
Red Maple	8,400
Scarlet Oak	3,100
Southern Red Oak	1,000
Sycamore	100
White Oak	3,600
White Pine	17,400
Yellow Poplar	48,100
Sawtimber Totals (bf)	120,200

Pulpwood	
Pine Pulpwood	5
Hard Hardwood Pulp	38
Soft Hardwood Pulp	129
Pulpwood Totals (Tons)	172

LOCATION and ACCESS: The tract is located in Wilkes County, North Carolina. From the intersection of Highway 115 and Highway 421 head south on Highway 115. Proceed 3.2 miles and turn right onto Balls Mill Road. Proceed 1.4 miles to a Casey & Company Forestry, PLLC sign located on the left side of the road. The tract will be located on the left side of the road.

TIMBER SHOWING: You are invited to look at the timber in the sale area at your convenience. Please call if you would like a personal showing or more information concerning the sale.

TIMBER INVENTORY: The volumes are based on a 100 percent tree count. Acreage estimates are based on data taken with a resource grade GPS unit. Hardwood sawtimber was tallied to a 10 inch or merchantable top. Pine sawtimber was tallied to an 8 inch or merchantable top. Pulpwood was tallied to a 4 inch or

merchantable top. Topwood pulpwood is not included in this volume estimate. Deductions for visible defects were made in the field. All sawtimber volumes are expressed in International ¼ inch Log Rule, form class 78. Pulpwood volumes are expressed in tons. These volumes are an estimate and cannot be guaranteed.

SALE INFORMATION: Bids for the timber will be received as a lump sum cash offer. No other terms will be accepted. The timber and pulpwood are being sold in the clearcut area. Only orange painted trees will be sold in the marked sale areas. Bids will be accepted by phone at 336-838-5766; by fax at 336-838-4465; by email at acasey@caseyandcompany.com, or by personal delivery to the office of Casey & Company Forestry, PLLC until 11:00 AM on February 25th, 2010. All faxes and emails will be confirmed by telephone prior to the bid opening. The owner reserves the right to reject any and all bids. The successful bidder will be notified within 24 hours of the bid opening. The successful bidder may be required to make a 10 percent deposit within 24 hours of notification. The balance will be paid in full within 30 days from the date of acceptance. The sellers will be responsible for timber deed preparation. The buyer will be responsible for all other closing costs. A \$750 performance deposit will be payable at closing and held in a non-interest bearing trust account until satisfactory completion of logging. The performance deposit does not limit the buyer's liability.

CONDITIONS OF THE SALE:

1. The Buyer will have 24 months, from the time of timber deed, to complete all timber-harvesting activities.
2. Casey & Company Forestry, PLLC will be notified at least 48 hours in advance of the initiation of logging activities, and 48 hours in advance of completion.
3. No trees, limbs, or other logging debris will be left in or across the sale boundaries. Debris will be removed immediately.
4. All requirements concerning stream obstructions as found in the NC General Statutes must be honored. The Buyer is also required to comply with the Best Management Practices as established by The State of North Carolina.
5. No boundary line trees or other trees not included in the sale will be cut. If any are cut, they will be paid for at the rate of \$400/MBF International ¼ log rule. The sale boundaries are marked with red paint and flagging, the boundaries of the marked sale area are marked with blue paint and flagging.
6. The Buyer agrees to indemnify and save harmless the Seller and his agents against all claims which may arise in connection with the Buyer's operations on the described tract, including fines resulting from poor logging practices or Workers Compensation Claims. Buyer guarantees their loggers will be covered by Workers Compensation and General Liability Insurance in the amount of 1 million dollars and will provide satisfactory evidence of coverage at closing and maintain same throughout all logging operations.
7. Trash will be kept picked up at all times. All trash will be removed from the property, not buried.
8. This contract may not be sold or assigned without written permission of the Seller.
9. Casey & Company Forestry retains the right to suspend the logging operation in the event of excessive wet weather or due to poor performance from the logger. Extensions may be granted for weather related suspensions.
10. The logger must complete a pre-harvest inspection with Casey & Company Forestry, PLLC.

Fern Absher Tract Wilkes County, N.C. Volume Summary¹

Stand Type	Clearcut	Marked Sale	Totals	Percent of Board Feet by Grade		
Stand Acres	8.7	0.7	9.4			
Avg. Volume per Acre (Mbf)	13.4	5.3	12.8			
Species	Sawtimber ² (Mbf)			Grade 1	Grades 2 & 3	Grade 4
Beech	2.2		2.2			
Black Birch	0.6		0.6			
Black Cherry	0.1		0.1	0%	100%	0%
Black Locust	0.3		0.3			
Chestnut Oak	21.0	1.2	22.2	12%	81%	7%
Cucumber	0.6		0.6			
Hickory	8.7		8.7			
Fraser Magnolia	0.6		0.6			
Northern Red Oak	2.6	0.6	3.2	31%	66%	3%
Red Maple	8.4		8.4	25%	73%	2%
Scarlet Oak	3.1		3.1	0%	61%	39%
Southern Red Oak	1.0		1.0	100%	0%	0%
Sycamore	0.1		0.1			
White Oak	3.6		3.6	8%	81%	11%
White Pine	17.4		17.4			
Yellow Poplar	46.2	1.9	48.1	50%	48%	2%

Sawtimber Totals (Mbf)	116.5	3.7	120.2
-------------------------------	-------	-----	-------

Product	Pulpwood ³ (Tons)	
Pine Pulpwood	5	5
Hard Hardwood Pulp	38	38
Soft Hardwood Pulp	129	129

Pulpwood Totals (Tons)	172	0	172
-------------------------------	-----	---	-----

1 The volumes are an estimate and cannot be guaranteed.

2 The sawtimber volumes are reported in units of thousand board feet and were calculated using International 1/4 inch Log Rule, Form Class 78. Volumes are based on a 100% tree count.

3 The pulpwood volumes are reported in tons and were calculated with tables developed by Dr. Richard Oderwald.

Fern Absher
Wilkes County, NC
Scale 1 Inch = 200 Feet
Contour Interval: 20 Feet

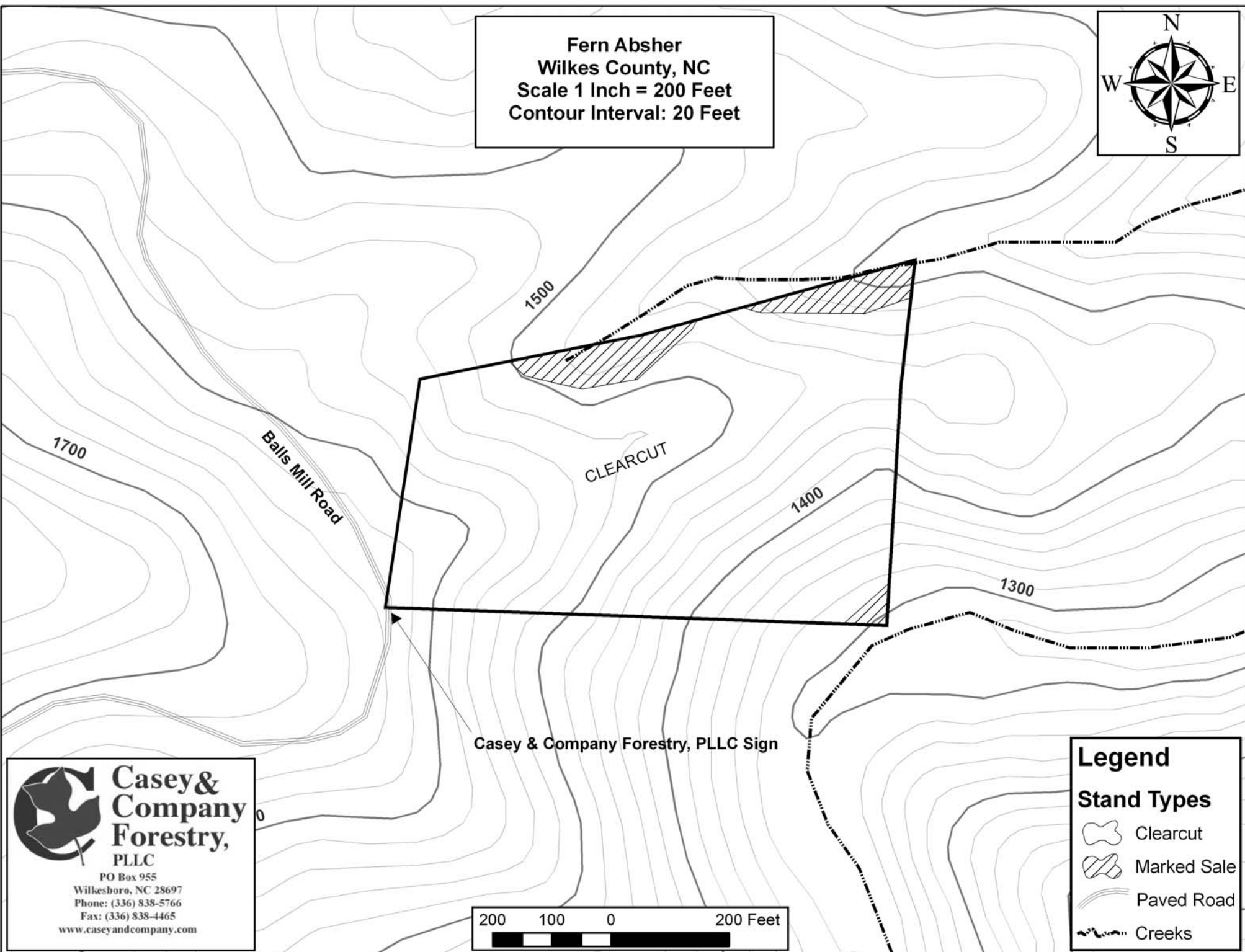

**Casey &
Company
Forestry,
PLLC**
PO Box 955
Wilkesboro, NC 28697
Phone: (336) 838-5766
Fax: (336) 838-4465
www.caseyandcompany.com

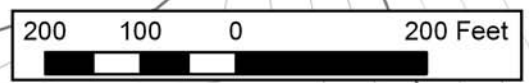

Legend

Stand Types

- Clearcut
- Marked Sale
- Paved Road
- Creeks

**Fern Absher
Timber Sale
Wilkes County, NC**

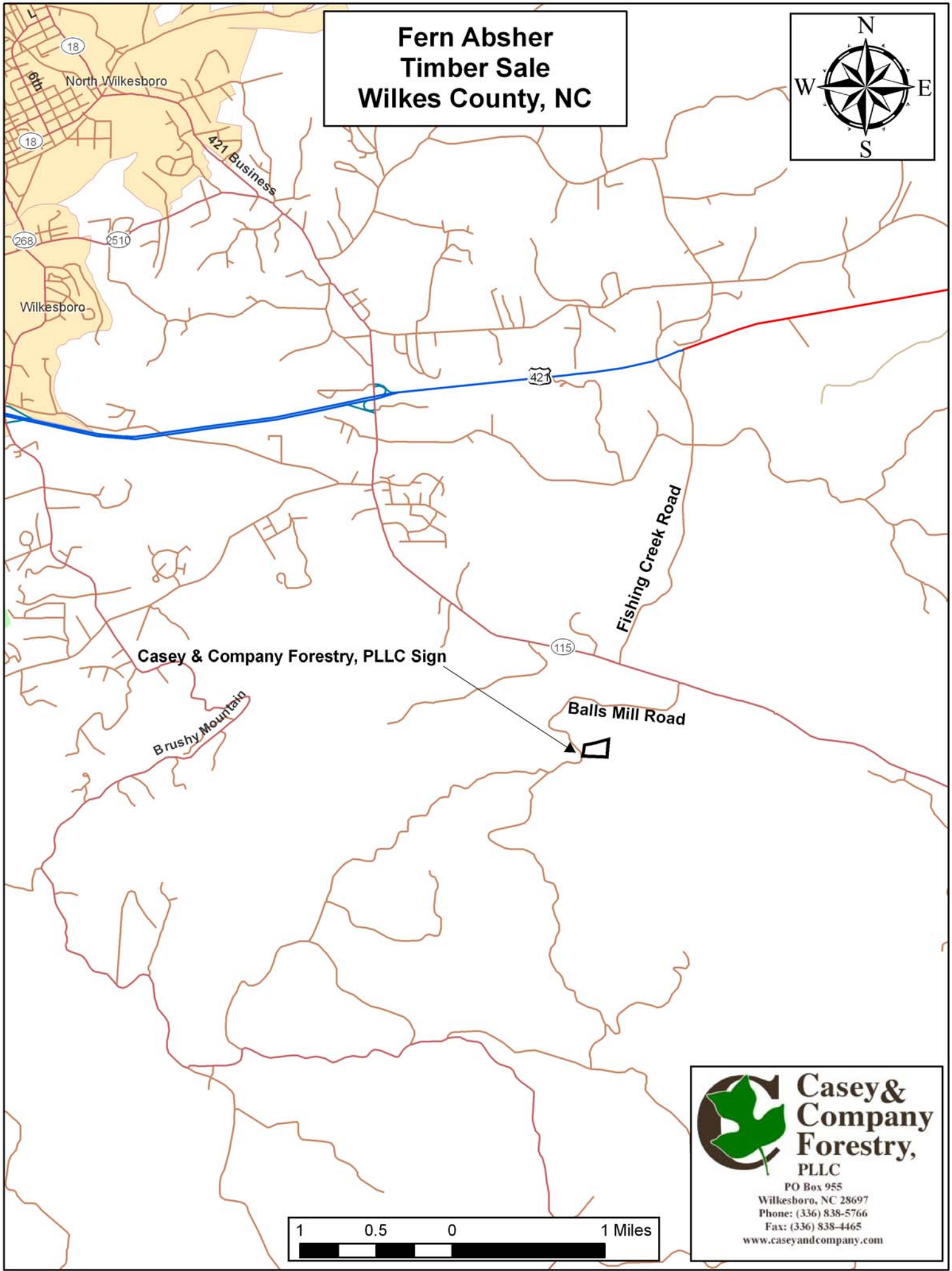

Casey & Company Forestry, PLLC Sign

Balls Mill Road

Fishing Creek Road

Brushy Mountain

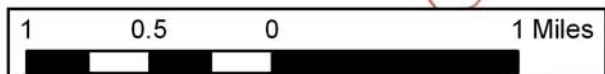

**Casey &
Company
Forestry,
PLLC**
PO Box 955
Wilkesboro, NC 28697
Phone: (336) 838-5766
Fax: (336) 838-4465
www.caseyandcompany.com